

SAE WHOLE STRAIGHT FLANGE 3000 PSI SERIES - SAE J518

Code: **8050..**
 Type: **SFL**

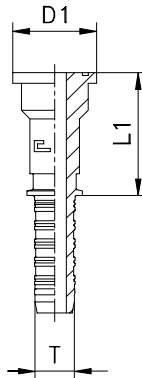

| CODE | I.D. hose T | | | Ø flange | D1 | L1 | PN [bar] |
|--------|-------------|------|-------|----------|------|------|----------|
| | DN | size | INCH | | | | |
| 805001 | 12 | -8 | 1/2 | 1/2 | 30 | 44,5 | 350 |
| 805002 | 12 | -8 | 1/2 | 3/4 | 38 | 49 | 350 |
| 805003 | 16 | -10 | 5/8 | 3/4 | 38 | 49,5 | 350 |
| 805004 | 19 | -12 | 3/4 | 3/4 | 38 | 50 | 350 |
| 805005 | 19 | -12 | 3/4 | 1 | 44,5 | 53 | 350 |
| 805006 | 25 | -16 | 1 | 1 | 44,5 | 53,5 | 280 |
| 805007 | 25 | -16 | 1 | 1 1/4 | 50,8 | 58 | 280 |
| 805008 | 31 | -20 | 1 1/4 | 1 1/4 | 50,8 | 59 | 210 |
| 805009 | 31 | -20 | 1 1/4 | 1 1/2 | 60,3 | 61 | 210 |
| 805010 | 38 | -24 | 1 1/2 | 1 1/2 | 60,3 | 62 | 185 |
| 805011 | 38 | -24 | 1 1/2 | 2 | 71,4 | 67 | 185 |
| 805012 | 51 | -32 | 2 | 2 | 71,4 | 68 | 165 |

Notes: If you wish to order a fitting in stainless steel, please change the first two digit from **80....** to **81....** .

SAE WHOLE 90° FLANGE 3000 PSI SERIES - SAE J518

Code: **8051..**
 Type: **SFL90**

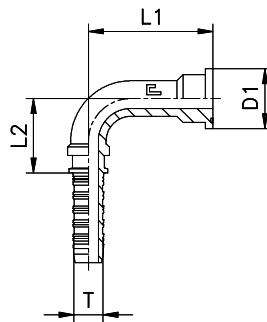

| CODE | I.D. hose T | | | Ø flange | D1 | L1 | L2 | PN [bar] |
|--------|-------------|------|-------|----------|------|------|-------|----------|
| | DN | size | INCH | | | | | |
| 805101 | 12 | -8 | 1/2 | 1/2 | 30 | 41 | 36 | 350 |
| 805102 | 12 | -8 | 1/2 | 3/4 | 38 | 46 | 36 | 350 |
| 805103 | 16 | -10 | 5/8 | 3/4 | 38 | 48 | 40 | 350 |
| 805104 | 19 | -12 | 3/4 | 3/4 | 38 | 57 | 47 | 350 |
| 805105 | 19 | -12 | 3/4 | 1 | 44,5 | 60 | 47 | 350 |
| 805106 | 25 | -16 | 1 | 1 | 44,5 | 61 | 63 | 280 |
| 805107 | 25 | -16 | 1 | 1 1/4 | 50,8 | 63,5 | 63 | 280 |
| 805108 | 31 | -20 | 1 1/4 | 1 1/4 | 50,8 | 74,5 | 75,5 | 210 |
| 805109 | 31 | -20 | 1 1/4 | 1 1/2 | 60,3 | 80 | 75,5 | 210 |
| 805110 | 38 | -24 | 1 1/2 | 1 1/2 | 60,3 | 90,5 | 101 | 185 |
| 805111 | 38 | -24 | 1 1/2 | 2 | 71,4 | 96,5 | 101 | 185 |
| 805112 | 51 | -32 | 2 | 2 | 71,4 | 112 | 137,5 | 165 |

Notes: If you wish to order a fitting in stainless steel, please change the first two digit from **80....** to **81....** .